

APPROVAL

TO: Charter Spectrum  
2150 S Central Expressway, Suite 300  
McKinney, TX 75070

DATE April 3, 2024

The Upshur County Commissioners Court offers no objections to the location on the right-of-way of your proposed 2" conduits line across CR 3639(Lindsey) Road as shown by accompanying drawings and notice dated 4/3/2024, except as noted below:

N/A

It is expressly understood that the Upshur County Commissioners Court does not purport, hereby, to grant and right, claim, title, or easement in or upon this county road; and it is further understood that in the future should for any reason Upshur County need to work, improve, relocate, widen, increase add to or any manner change the structure of this right-of-way line, this line, if affected, will be moved under the direction of the Upshur County Engineer and shall be relocated at the complete expense of the owner. Upshur County shall be notified a minimum of 48 hours prior to the beginning of any work.

All work on the county right-of-way shall be performed in accordance with the County Engineer's instructions. The installation shall not damage any part of the highway and adequate provisions must be made to cause minimum inconvenience to traffic and adjacent property owners. Special specifications for placing this line are as follows:

1. All ground lines are to be installed a minimum of 36 inches below the flowline of the adjacent drainage or borrow ditch.
2. All excavations within the right-of-way and not under surfacing shall be backfilled by tamping in 6 inch horizontal layers. All surplus material shall be removed from the right-of-way and the excavation finished flush with surrounding natural ground.
3. Lines crossing under surfaced roads and under surfaced cross roads within the right-of-way shall be placed by boring. Boring shall extend from crown line to crown line.
4. All lines under roads carrying pressure in excess of 50 psi shall be enclosed in satisfactory casing extending from right-of-way line to right-of-way line. Pipe used for casing may be of any type approved by the County Engineer and shall be capable of Supporting the load of roadbed and traffic and shall be so constructed that there will be no leakage of any matter through the casing for its entire length. Inside diameter of casing shall be at least 2 inches greater than the largest outside diameter of carrier pipe, joint or couplings. (Encasement is not required on lines installed 48 inches or greater below flowline.)
5. All lines, where practicable, shall be located to cross roadbed at approximately right angles thereto. No lines are to be installed under or within 50 feet of either end of a bridge unless approved by the County Engineer in writing. No lines shall be placed inside any culvert or within 10 feet of the closest point of same.
6. Parallel lines will be installed as near the right-of-way lines as is possible and no parallel line will be installed in the roadbed or between the drainage ditch and roadbed unless approved by the County Engineer in writing.
7. Overhead lines will have a minimum clearance of 18 feet above the road surface at point of crossing.
8. Operations along roadways shall be performed in such a manner that all excavated material be kept off the pavements at all times, as well as all operating equipment and materials. Do not use equipment or installation procedures which will damage any road surface or structure. The cost of any repairs to road surfaces, roadbed, structures or other right-of-way features as direct result of this installation will be borne by the owner of this line.
9. Barricades, warning signs, lights and flagmen, when necessary, shall be provided by the contractor or owner. One half of the traveled portion of the road must be open to traffic at all times. All traffic control shall be in accordance with the requirements of the current version of the Texas MUTCD.
10. Utility company shall install adequate erosion control measures for any excavation work being performed.

APPROVED: \_\_\_\_\_

Road Administrator

APPROVED: \_\_\_\_\_

Chairperson, Upshur County Commissioners Court  
Revised 11/30/10

NOTICE OF PROPOSED INSTALLATION  
PIPE AND/OR UTILITY LINES

DATE: 4/03/2024

TO: UPSHUR COUNTY COMMISSIONERS COURT  
c/o UPSHUR COUNTY ENGINEER  
UPSHUR COUNTY ROAD & BRIDGE DEPARTMENT  
P. O. BOX 730  
Gilmer, TX 75644

EXPIRES: \_\_\_\_\_

Formal notice is hereby given that Charter-Spectrum proposes to bore a 2-2" HDPE conduits line within the right-of-way of County Road CR 3639 as follows:

Charter-Spectrum is proposing to install approx. 850' of underground conduits e/w fiber optic cable, and approx. 2 Vaults within the ROW of CR 3639.

The location and description of the proposed line and appurtenances is more fully shown by three copies of drawings attached to this notice. The line will be constructed and maintained on the County right-of-way as directed by the County Engineer in accordance with current Upshur County specifications.

Construction of this line will begin on or after the 6th day of June, 2024 and will be completed within 90 days of the date of approval.

Firm Charter Spectrum  
By Marwah Altale  
Title APM  
Address 2150 S Central Expressway, Suite 300,  
McKinney, TX 75070

- NOTE: 1. This form to be submitted in triplicate for each proposed installation.  
2. The permit shall be in effect until the utility line is removed from the right of way.  
3. Inform the County Engineer if work is not completed within this time.

**SHEET INDEX**

1. COVER SHEET
2. GENERAL NOTES
3. UPSHUR COUNTY GUIDELINES OF MIXED UTILITY LINES
4. OSP PLAN

**SCOPE OF WORK**

CHARTER COMMUNICATIONS PROPOSES TO INSTALL FIBER OPTIC CABLE ALONG CR 3533 IN UPSHUR COUNTY.

DESCRIPTION	UNITS	QUANTITY
DIRECTIONAL BORE	LF	850
TRENCH	LF	
PULL EXISTING CONDUIT		
BORE FITS	EA	
NEW VAULTS	EA	2
NEW PEDESTALS	EA	
POWER SUPPLY	EA	
AERIAL RISER	EA	
NEW STRAND	LF	
ANCHORS	EA	
NEW POLES	EA	
EXISTING POLES	EA	
TOTAL PROJECT FOOTAGE	LF	850



RDOF TX CLUSTER 2 TBD W138E (3993814)

BIG SANDY, TX 75755  
 UPSHUR COUNTY  
 APRIL 2, 2024

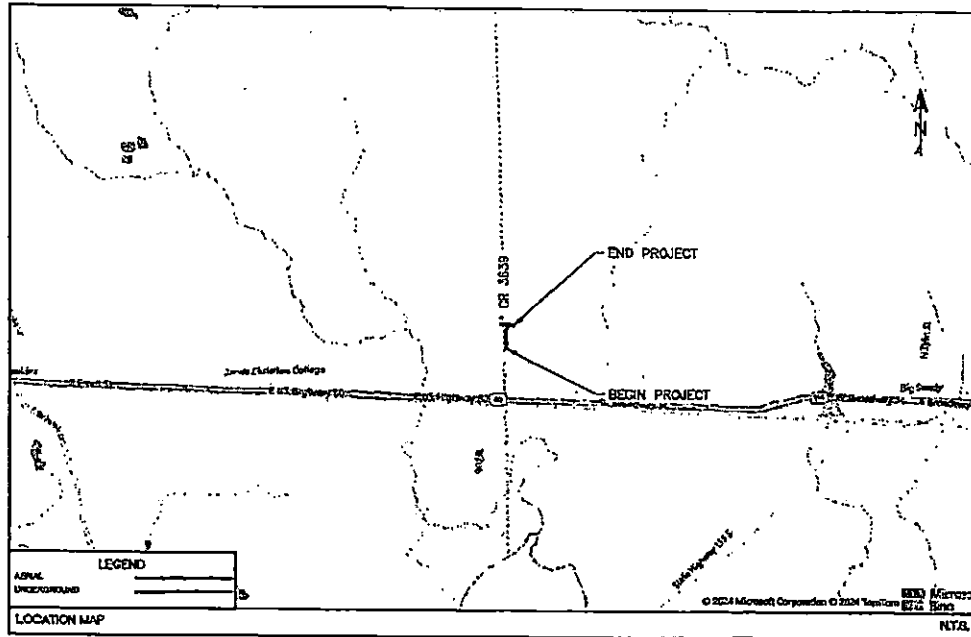

**PROJECT INFORMATION**

CONTACT: CHARTER-SPECTRUM  
 CONTACT: OSCAR BUSTO  
 PHONE: 409-623-6112  
 EMAIL: oscar.busto@charter.com

CONTACT:  
 NEN BAILEY, SR. PROJECT MANAGER  
 LJA ENGINEERING, INC  
 2150 S CENTRAL EXPY, SUITE 300  
 MCKINNEY, TX 75070  
 NENBAILEY@LJA.COM  
 214-624-2500

**SUBMITTAL PREPARED BY**



6000 N. General Expressway, Suite 400  
 Dallas, TX 75226  
 469-623-0710  
 1286 FIVE REDDS WOODS, F-1386

CONTACT:  
 JOSH LOWME  
 PHONE:  
 469-623-8223

SUBMITTED FOR APPROVAL BY: \_\_\_\_\_  
 TITLE OF REVIEWER: \_\_\_\_\_ DATE: \_\_\_\_\_

**NOTE**  
 THE PROJECT HAS BEEN PROVIDED AS SHOWN IN THIS PLAN IN ACCORDANCE WITH THE AVAILABLE INFORMATION AND IS NOT GUARANTEED BY THE CONTRACTOR. THE CONTRACTOR SHALL BE RESPONSIBLE FOR VERIFYING THE EXISTING UTILITIES AND CONDITIONS BEFORE CONSTRUCTION. THE CONTRACTOR SHALL NOTIFY THE ENGINEER AND THE OWNER PRIOR TO CONSTRUCTION IF THERE ARE ANY CONDITIONS REQUIRING THE ROAD.

LOCATION OF EXISTING UTILITIES AND APPROXIMATE UTILITY POLES AND APPROXIMATE LOCATIONS ONLY. THE CONTRACTOR SHALL DETERMINE THE EXACT LOCATION OF ALL UTILITIES UTILIZED FROM THIS RECORDING AND SHALL BE FULLY RESPONSIBLE FOR ANY AND ALL DAMAGES WHICH MIGHT OCCUR.



Know what's below. Call before you dig.

1. 2. 3. 4. 5. 6. 7. 8. 9. 10. 11. 12. 13. 14. 15. 16. 17. 18. 19. 20. 21. 22. 23. 24. 25. 26. 27. 28. 29. 30. 31. 32. 33. 34. 35. 36. 37. 38. 39. 40. 41. 42. 43. 44. 45. 46. 47. 48. 49. 50. 51. 52. 53. 54. 55. 56. 57. 58. 59. 60. 61. 62. 63. 64. 65. 66. 67. 68. 69. 70. 71. 72. 73. 74. 75. 76. 77. 78. 79. 80. 81. 82. 83. 84. 85. 86. 87. 88. 89. 90. 91. 92. 93. 94. 95. 96. 97. 98. 99. 100.

**GENERAL NOTES**

1. ALL EXISTING FACILITIES CURRENTLY IN SERVICE MUST REMAIN IN SERVICE, UNLESS OTHERWISE NOTED IN THE DRAWINGS.
2. CONDITION OF THE ROAD AND/OR RIGHT-OF-WAY, UPON COMPLETION OF JOB SHALL BE AS GOOD AS OR BETTER THAN PRIOR TO STARTING WORK.
3. ALL EFFORTS HAVE BEEN MADE TO LOCATE ALL EXISTING UTILITIES ON PLANS, IT SHALL BE THE CONTRACTOR'S RESPONSIBILITY TO LOCATE AND PROTECT ALL SAID UTILITIES AS WELL AS SERVICE CONNECTIONS (WHETHER OR NOT INDICATED ON PLANS), PRIOR TO CONSTRUCTION, CONTRACTOR SHALL COORDINATE WITH UTILITY COMPANIES TO VERIFY LOCATION OF EXISTING UTILITIES.
4. CALL UTILITY COORDINATING COMMITTEE 48 HRS. PRIOR TO CONSTRUCTION AT 1-800-344-8377 (1-800-DIG-1033).
5. CONTRACTOR IS RESPONSIBLE FOR COORDINATING WITH GAS, OIL, ELECTRIC, TELEPHONE, FIBER OPTIC, CABLE TV, SEWER AND WATER UTILITIES OWNERS, ETC. FOR ANY RELOCATION AND/OR PROTECTION OF EXISTING LINES OR CABLES AS REQUIRED, DUE TO CONSTRUCTION ACTIVITIES.
6. CONTRACTOR TO PROVIDE A MINIMUM OF 2' OF CLEARANCE AT ALL CROSSINGS OF SANITARY SEWERS, STORM SEWERS, ELECTRIC, WATER LINES AND LEADS.
7. CONTRACTOR MUST COMPLY WITH OSHA REQUIREMENTS, TDDOT STD. SPEC. (DIVISION IV, STRUCTURES) AND UTILITY OWNER STANDARDS FOR TRENCHING, BACKFILLING, EXCAVATION AND SHORING REQUIREMENTS.
8. THE CONSTRUCTION CONTRACTOR SHALL ALSO BE SOLELY RESPONSIBLE FOR THE MEANS, METHODS, SEQUENCE, PROCEDURES, TECHNOLOGY OR SCHEDULING ALL PORTIONS OF THE WORK OF CONSTRUCTION IN ACCORDANCE WITH THE CONTRACT DOCUMENTS. THE CONSTRUCTION CONTRACTOR SHALL ALSO BE SOLELY RESPONSIBLE FOR SAFETY IN OR ABOUT THE JOB SITE IN ACCORDANCE WITH ANY HEALTH OR SAFETY REGULATIONS, REGULATIONS, STANDARDS OR CODES REQUIRED BY OSHA, OR ANY OTHER REGULATORY AGENCY.
9. NO MORE TRENCH OPENED AT ONE TIME THAN CAN BE BACKFILLED AND COMPACTED IN 24 HRS. AT THE END OF EACH WORK PERIOD, NO TRENCH LEFT OPEN OVERNIGHT UNLESS COVERED BY METAL PLATES.
10. CONTRACTOR TO TAKE NECESSARY PRECAUTIONS TO PROTECT ROOT SYSTEMS OF TREES, PLANTS AND TREES ALONG THE AREA OF EXCAVATION.
11. EXISTING PAVEMENT, CURBS, SIDEWALKS, AND DRIVEWAYS DAMAGED OR REMOVED DURING CONSTRUCTION SHALL BE REPLACED BY BIDDOR CONTRACTOR IN CONFORMANCE WITH LOCAL STANDARDS. WHEELWASH RAMP'S SHALL BE CONSTRUCTED AT ALL PAVEMENT CROSSINGS WHERE CURB RISE/RAIL IS REQUIRED FOR INSTALLATION OF THE UNDERGROUND CONDUIT SYSTEM.
12. CONTRACTOR SHALL BE RESPONSIBLE FOR DETERMINING BORE PIT LOCATIONS AND DRAINAGE INFORMATION SHOWN ON PLANS ARE FOR REFERENCE PURPOSE ONLY.
13. IF IT BECOMES NECESSARY TO OPERATE MACHINERY ON A PORTION OF THE PAVEMENT, PRECAUTIONS MUST BE TAKEN TO PREVENT ANY DAMAGE WHATSOEVER TO THE PAVEMENT.
14. CONTRACTOR SHALL INSTALL TRAFFIC CONTROL DEVICES IN CONFORMANCE WITH PART 9 OF THE TEXAS MANUAL ON UNIFORM TRAFFIC CONTROL DEVICES (2014 EDITION) AND TDDOT STANDARDS DURING CONSTRUCTION TO PROVIDE COMPLETE SAFETY TO THE GENERAL PUBLIC.
15. BORE PITS CLOSER THAN 12" FROM THE EDGE OF PAVEMENT MUST BE PROTECTED BY TYPE III BARRICADES. OTHER PITS MUST BE SEALED OFF BY ORANGE PLASTIC MESH FENCING AND CONES OR DRUMS.
16. CONSTRUCTION EQUIPMENT LEFT OVERNIGHT IN TDDOT RIGHT-OF-WAY SHALL BE SECURED OFF WITH ORANGE PLASTIC MESH FENCING AND BE PLACED AT LEAST 30' FROM THE EDGE OF PAVEMENT. EQUIPMENT LOCATED CLOSER THAN 30' MUST BE PROTECTED BY CONCRETE TRAFFIC BARRIERS (CTRB).
17. CONTRACTOR WILL BE RESPONSIBLE FOR REFLECTORS AND MAINTAINING TRAFFIC SIGNS

AND PAVEMENT MARKINGS, INCLUDING CENTERLINES, BARRIER LINES, LANE LINES, PAISED PAVEMENT MARKINGS, ETC.

18. CONTRACTOR IS REQUIRED TO PREPARE AND INCLUDE AN APPROVED EROSION WATER POLLUTION PREVENTION (SWPP) PLAN IN ACCORDANCE WITH STATE AND LOCAL REQUIREMENTS AND CONTRACT DOCUMENTS. CONTRACTOR SHALL KEEP ALL DRAINAGE A SPILL OUT OF DRAINAGE, CLEVERETS, AND DROP BULBS AND INSURE THAT THEY DO NOT BECOME CLOGGED AS A RESULT OF CONSTRUCTION ACTIVITIES.
19. ANY DISCREPANCIES FROM WHAT IS SHOWN ON THE PLANS SHALL BE BROUGHT TO THE ATTENTION OF THE ENGINEER.
20. THE CONDUIT, FITTINGS, CONDUIT JOINTS AND ACCESSORIES SHALL BE INSPECTED UPON DELIVERY AND DURING THE PROGRESS OF THE WORK. ANY MATERIAL FOUND TO BE DEFECTIVE WILL BE REJECTED BY THE OWNER'S REPRESENTATIVE AND THE CONTRACTOR SHALL REMOVE SUCH DEFECTIVE MATERIAL FROM THE SITE OF THE WORK.
21. CONTRACTOR SHALL COORDINATE AND NOTIFY ANY UTILITY ADJACENT WITH THE UTILITY COMPANY, NO FACILITY MAY BE CONSIDERED ABANDONED WITHOUT WRITTEN CONSENT FROM UTILITY OWNER.
22. CONTRACTOR IS TO PLUG ALL INSTALLED DUCTS.
23. THE CONSTRUCTION CONTRACTOR SHALL PLACE UTILITY LOCATION TAPE OVER ALL EXPOSED CONDUIT.
24. ALL PROPOSED EDGES SHALL BE GRADUAL SLOPES WITH A MINIMUM 20-FOOT RADIUS, UNLESS NOTED ON THE PLANS.
25. CONTRACTOR SHALL CONSTRUCT HORIZONTAL DIRECTIONAL DRILL IN ACCORDANCE WITH PART 9 TRENCHING MANUAL GUIDE FOR USE OF MAN-HORIZONTAL DIRECTIONAL DRILLING FOR PLACEMENT OF POLYETHYLENE PIPE OR CONDUIT UNDER OBSTACLES INCLUDING OTHER CROSSINGS.
26. CONTRACTOR TO PROVIDE AND PLACE SHOULDER MARK TAPE IN EACH INSTALLED DUCT.
27. ALL PROPOSED TELECOM FACILITIES SHOULD BE INSTALLED AT MIN. DEPTH IS 48" FOR LONGITUDINAL LINES AND MIN DEPTH IS 18" FROM LOWEST POINT OF GRADE FOR CROSSINGS.
28. USE OF WATER AND OTHER FLUIDS IN CONNECTION WITH BORING OPERATIONS WILL BE PERMITTED ONLY IN SUFFICIENT QUANTITY TO LUBRICATE DOWN BIT AND PROVIDE A SMOOTH FLOW OF CUTTINGS. JETTING WILL NOT BE PERMITTED.
29. OPERATIONS ON THE ROADWAY SHALL BE PERFORMED IN SUCH A MANNER THAT OPERATING EQUIPMENT AND EXCAVATED MATERIAL ARE KEPT OFF THE PAVEMENT AT ALL TIMES.
30. BARRICADES AND WARNING SIGNS, AND FLASHERS WHEN NECESSARY, SHALL BE PROVIDED BY THE CONTRACTOR OR OWNER. ONE-HALF THE TRAVEL PORTION OF THE ROADWAY MUST BE OPEN TO TRAFFIC AT ALL TIMES. CONTRACTOR TO REFER TO COMPLY WITH TEXAS MOTOR BARRICADE AND CONSTRUCTION STANDARDS.
31. WORK PERFORMED ON BALDADO RIGHT-OF-WAY IS SUBJECT TO THE CONSIDERANCE OF THE BALDADO COMPANY. WORK PERFORMED WITHIN WATERWAYS, SUCH AS RIVERS, CREEKS, DRAVOTS, AND DRAINAGE DITCHES IS SUBJECT TO THE RULES & REGULATIONS OF THAT APPROPRIATE GOVERNMENTAL AGENCY.
32. APPROPRIATE EXEMPTION/APPROVAL MUST BE SECURED FOR PROJECT AREAS OUTSIDE THE RIGHT-OF-WAY. NO WORK SHALL BE PERFORMED ON PRIVATE PROPERTY UNLESS RIGHT OF ENTRY AND ENGAGEMENT HAS BEEN OBTAINED.
33. CONTRACTOR TO CONTACT TELCOM ENGINEER A MINIMUM OF 2-WEEKS PRIOR TO CONSTRUCTION.

34. ALL FIBER OPTIC CABLE AND COOPER BASED FACILITIES WILL BE GRADED BY THE UTILITY OWNER. CONTRACTOR SHALL BE RESPONSIBLE FOR NOTIFYING PERTINENT UTILITIES OF CONDUIT STRUCTURE COMPLETION FOR INSPECTION APPROVAL.

35. UTILITY CONTRACTOR TO CONTACT UTILITY OWNER OF 48 HOURS PRIOR TO CONNECTION TO EXISTING MANHOLE OR DUCTS TO COORDINATE ON-SITE INSPECTION BY UTILITY PERSONNEL.
36. CONTRACTOR TO PROVIDE OVERHEAD POLE SUPPORT WHENEVER CONSTRUCTION EXCAVATION IS WITHIN 2' OF AN OVERHEAD POLE.
37. CONTRACTOR MUST OBTAIN PERMISSION FROM AFFECTED PROPERTY OWNER FROM ANY CONSTRUCTION RELATED ACTIVITIES THAT MAY ENCROACH ON ADJACENT PRIVATE PROPERTY.
38. CONTRACTOR SHALL NOTIFY CAPITAL METRO 48 HOURS IN ADVANCE OF CONSTRUCTION.
39. CONTACT LAUREE SHAR WITH CAPITAL METRO AT 512-424-12008 LAUREE@CAPITALMETRO.ORG PRIOR TO RELOCATING ANY BUS STOP OR GETTING ANY TRAFFIC CONTROL DEVICES AFFECTING ANY BUS STOP OR SERVICES.
40. ALSTON ENERGY FACILITIES - OFF INSTALLED VALVES, MANHOLES, AND BONDING THE CORE SERVICE TRENCHES TO HOMES AND BUSINESSES SHALL MAINTAIN 2' WORK SEPARATION FROM EXISTING ALSTON ENERGY FACILITIES UNLESS OTHERWISE AGREED UPON WITH THE DESIGNATED ALSTON ENERGY FIELD PERSONNEL.
41. CONTRACTOR SHALL BE RESPONSIBLE FOR NOTIFYING PERTINENT UTILITIES OF CONDUIT STRUCTURE COMPLETION FOR INSPECTION APPROVAL.
42. ONLY 1 SET PER CONDUIT FOR EACH TELECOMMUNICATION PROVIDER AT ALL POLE LOCATIONS SHOWN ON PLANS.
43. ALL VALVES, MANHOLES, AND MANHOLES TO BE PLACED AT FINAL GRADES. TEMPORARY PILES OR CUTS NEED TO BE USED AT EACH SITE TO THAT THE MINIMUM OF 2' NEARBY MORNING SPACE EXISTS AROUND THE PERIMETER OF EACH OPENING.

PROJECT: SPECTRUM 3993814 - RD OF TX CLUSTER 2 - TBD W38E - UPGRADE COUNTY GENERAL NOTES  
 DRAWN BY: MA  
 CHECKED BY: MA  
 DATE: 4/17/2024



**SPECTRUM**  
**3993814**  
 RD OF TX CLUSTER 2 TBD W38E  
 UPGRADE COUNTY  
 GENERAL NOTES

LOCATION OF EXISTING UNDERGROUND AND CONDUIT UTILITIES ARE APPROXIMATE. CONTRACTOR SHALL DETERMINE THE EXACT LOCATION OF ALL CONDUIT UTILITIES PRIOR TO BEGINNING WORK AND SHALL BE FULLY RESPONSIBLE FOR ANY AND ALL DAMAGES WHICH MIGHT OCCUR.



|                 |           |              |        |
|-----------------|-----------|--------------|--------|
| DESIGN BY:      | LJA       | CHECKED BY:  | MA     |
| DRAWN BY:       | MA        | APPROVED BY: | MS     |
| PROJECT NUMBER: | 23-R14E   | SHEET:       | 2 OF 4 |
| DATE:           | 4/17/2024 | PAGE:        | 2      |

**UPSHUR COUNTY ROAD AND BRIDGE DEPARTMENT GUIDELINES OF BURIED UTILITY LINES**

1. FIBER OPTIC LINES WILL BE CONSTRUCTED NO LESS THAN FORTY-EIGHT INCHES (48") LOWER THAN THE LOWEST PART OF THE DRAINAGE OR BAR DITCH, AND THE DRAINAGE IS TO BE CONSIDERED AT LEAST TWO FEET (2') BELOW THE CENTER OF THE ROADWAY.
2. LOCATION - UTILITY LINES SHALL BE LOCATED TO AVOID OR MINIMIZE THE NEED FOR ADJUSTMENT FOR FUTURE ROAD IMPROVEMENTS AND TO PERMIT ACCESS TO THE UTILITY LINES FOR THEIR MAINTENANCE WITH MINIMUM INTERFERENCE TO ROAD TRAFFIC. NO LINE OR CABLE SHALL BE BURIED IN THE CENTER OF THE DITCH. ALL LINES MUST BE PLACED IN THE BACK SLOPE, NOT TO INTERFERE WITH THE DRAINAGE IN THE DITCH. ANY BURIED CABLE SHALL NOT BE PLACED ON TOP, OR INSIDE, OF ANY EXISTING CULVERTS.
3. ENCASEMENT - IN GENERAL, UNDERGROUND UTILITY LINE CROSSINGS SHALL BE ENCASED IN THE INTEREST OF SAFETY, PROTECTION OF THE UTILITY, PROTECTION OF THE ROADWAY, AND FOR ACCESS TO THE UTILITY.
4. MARKERS - THE UTILITY COMPANY SHALL PLACE A READILY IDENTIFIABLE AND SUITABLE MARKER AT EACH RIGHT OF WAY LINE WHERE IT IS CROSSED BY ANY:
  - ⓐ HIGH PRESSURE GAS OR LIQUID PETROLEUM LINE, EXCEPT WHERE MARKED BY A VENT.
  - ⓑ COMMUNICATION CABLES.
  - ⓒ WATER LINE
  - ⓓ UNDERGROUND POWER LINES
  - ⓔ CABLE TELEVISION AND COPPER CABLE
5. METHODS OF INSTALLATION - ALL LINES PLACED UNDER ANY EXISTING ROADWAY SHALL BE INSTALLED BY BORING OR TUNNELING, ENCASING OF THE LINE MAY BE REQUIRED. NO TRENCHING OR CUTTING OF THE COUNTY ROAD IS TO BE DONE WITHOUT APPROVAL. THE USE OF EXPLOSIVES FOR ANY EXCAVATIONS ON THE RIGHT OF WAY INCIDENT TO UTILITY LINE INSTALLATION SHALL NOT BE PERMITTED. DURING INSTALLATION, ALL TRAFFIC CONTROL DEVICES (SIGNS, MARKINGS, BARRICADES, ETC.) MUST BE USED TO WARN MOTORISTS OF THE CONSTRUCTION ACTIVITY AND SHALL CONFORM TO THE TMDOTD.
6. PEDESTAL - ABOVE-GROUND PEDESTALS OR OTHER UTILITY APPURTENANCES INSTALLED AS A PART OF AN UNDERGROUND COMMERCIAL LINE SHALL BE LOCATED AT OR NEAR THE RIGHT OF WAY LINE, WELL OUTSIDE THE ROAD MAINTENANCE OPERATION AREA.
7. PLACEMENT - NO LINE SHALL BE PLACED THROUGH A CULVERT (ROAD OR ACCESS DRIVEWAY PIPE). PARALLEL WATER, HIGH-PRESSURE GAS, AND LIQUEFIED PETROLEUM LINES SHOULD BE CONSTRUCTED ON PRIVATE PROPERTY. WHEN THE LINE IS TO CROSS THE COUNTY RIGHT OF WAY AND ROADWAY ALL RULES AND REGULATIONS ARE TO BE FOLLOWED ARE DESCRIBED WITHIN.
8. THE COUNTY ROAD ENGINEER MUST BE NOTIFIED PRIOR TO THE BEGINNING OF CONSTRUCTION IN ORDER TO ENSURE ALL WORK HAS BEEN APPROVED IN COMMISSIONERS COURT. NOTICE MUST BE MADE NO LATER THAN 48 HOURS PRIOR TO COMMENCING CONSTRUCTION.
9. ALL DAMAGE TO THE ROADWAY AND COUNTY RIGHT OF WAY WILL BE REPAIRED TO THEIR ORIGINAL CONDITION AND TO THE SATISFACTION OF THE COUNTY ROAD ENGINEER. UPSHUR COUNTY WILL NOT BE RESPONSIBLE FOR ANY DAMAGE WHICH OCCURS TO BURIED UTILITY LINES WITHIN THE COUNTY ROAD OR COUNTY RIGHT OF WAY.
10. UPSHUR COUNTY RESERVES THE RIGHT TO REQUIRE APPLICANT TO RELOCATE, OR LOWER, ANY SUCH LINE AT NO COST TO UPSHUR COUNTY SHOULD ANY ALTERATIONS OR ROAD CHANGES BECOME NECESSARY.
11. UPSHUR COUNTY IS NOT RESPONSIBLE FOR ANY DAMAGE THAT MIGHT OCCUR TO ANY EXISTING UTILITY LINE IN THE COUNTY RIGHT OF WAY, OR FUTURE LINE PLACED IN THE COUNTY RIGHT OF WAY.
12. THE UTILITY SHALL BE PLACED AND MAINTAINED ON THE COUNTY RIGHT OF WAY IN ACCORDANCE WITH ANY AND ALL COVERING LAWS, RULES, AND REGULATIONS.
13. ALL DEPTHS OF UTILITY LINES MUST BE AS REQUIRED AND APPROVED.
14. ALL ROADS SHALL BE BORED IN ACCORDANCE WITH THE UTILITY ACCOMMODATION POLICY OF THE TEXAS DEPARTMENT OF TRANSPORTATION (LATEST VERSION).
15. ALL WORK SITES WILL BE BARRICADED DURING THE CONSTRUCTION PERIOD. NO OPEN HOLES IN FIRE COUNTY ROAD WILL BE LEFT UNATTENDED OR UN-BARRICADED DURING AND AFTER CONSTRUCTION PERIOD.
16. CONSTRUCTION SHALL BE IN STRICT ACCORDANCE TO THE LATEST TEXAS MANUAL ON UNIFORM TRAFFIC CONTROL DEVICES FOR STREETS AND HIGHWAYS, PUBLISHED BY THE TEXAS DEPARTMENT OF TRANSPORTATION, AND ALL OTHER STATE AND FEDERAL LAWS GOVERNING UTILITY CONSTRUCTION.

LOCATION OF EXISTING UNDERGROUND AND OVERHEAD UTILITIES AND APPROPRIATE LOCATIONS ON THE CONSTRUCTION SHALL DETERMINE THE EXACT LOCATION OF ALL UTILITIES PRIOR TO BEGINNING WORK. CONTRACTOR SHALL BE FULLY RESPONSIBLE FOR ANY AND ALL DAMAGES WHICH MAY OCCUR.



Know what's Below,  
Call before you dig.

**Spectrum**

**LJA**  
LJA TELECOM

**SPECTRUM**  
3993814  
RD0F TX CLUSTER 2 T8D W38E  
UPSHUR COUNTY  
GUIDELINES OF BURIED UTILITY LINES

|                         |                 |
|-------------------------|-----------------|
| DESIGN BY: LJA          | CHECKED BY: MA  |
| DRAWN BY: MA            | APPROVED BY: KB |
| PROJECT NUMBER: ES-N14E | SHEET: 3 OF 4   |
| DATE: 4/2/2014          | PAGE: 3         |

C:\Users\j... Desktop\County Road and Bridge Department Guidelines of Buried Utility Lines.dwg

BIG SANDY, TX  
UPSHUR COUNTY

0 25 50 75 100  
FEET  
HORIZONTAL SCALE 1" = 100'



LEGEND

|                             |   |
|-----------------------------|---|
| AERIAL                      |   |
| UNDERGROUND                 |   |
| FENCE LINE                  |   |
| EDGE POLE                   | X |
| PROP. 17" X 33" X 24" PFD   | ☒ |
| PROP. 24" X 36" X 24" VAULT | ☐ |

NOTE:  
CONTRACTOR IS RESPONSIBLE TO MAINTAIN TRAFFIC CONTROL AND BE FORTH IN THE TEXAS MANUAL ON CHANGING TRAFFIC CONTROL DEVICES FOR STREET AND HIGHWAYS.

NOTE:  
UNDERGROUND UTILITIES HAVE BEEN PLOTTED FROM AVAILABLE RECORDS AND FIELD OBSERVATIONS BUT ARE NOT NECESSARILY EXACT. IT IS THE CONTRACTOR'S RESPONSIBILITY TO FIELD LOCATE ALL UNRECORDED OBSTRUCTIONS AND UTILITIES PRIOR TO CONSTRUCTION. COMPLETE REPAIR OF ANY AND ALL DAMAGES INCURRED SHALL BEAT THE EXPENSE OF THE CONTRACTOR.

CAUTION:  
EXIST. BURIED POWER, TELEPHONE, CTV, GAS, ELECTRIC, WATER, SANITARY SEWER & STORM SEWER FACILITIES IN CONSTRUCTION AREA AND HAVE NOT BEEN FIELD LOCATED. CONTRACTOR TO VERIFY EXACT LOCATION AND DEPTH PRIOR TO ANY DITCHING AND/OR DORING.

NOTE: THE RIGHT-OF-WAY (ROW) SHOWN ON THESE PLANS IS BASED ON PUBLICLY AVAILABLE INFORMATION AND IS NOT EXACT. IT IS THE CONTRACTOR'S RESPONSIBILITY FOR DETERMINING THAT ALL FACILITIES ARE CONSTRUCTED WITHIN THE ROW OR IN A COMMUNICATIONS BASEMENT. THE CONTRACTOR SHALL NOTIFY THE ENGINEER AND THE OWNER PRIOR TO CONSTRUCTION IF THERE ARE ANY CONCERNS REGARDING THE ROW.

CAUTION: THE CONTRACTOR TO LOCATE & VERIFY ALL EXISTING UTILITIES PRIOR TO CONSTRUCTION

**Spectrum**

**LJA**  
LJA TELECOM

SPECTRUM  
3993814  
ROOF TX CLUSTER 2 TSD W38E  
UPSHUR COUNTY  
OSP PLAN

|             |               |              |        |
|-------------|---------------|--------------|--------|
| DESIGN BY:  | LJA           | CHECKED BY:  | MA     |
| DRAWN BY:   | MA            | APPROVED BY: | ED     |
| PROJECT NO: | 20203-ES-N142 | SHEET:       | 4 OF 4 |
| DATE:       | 4/5/2024      | PAGE:        | 4      |

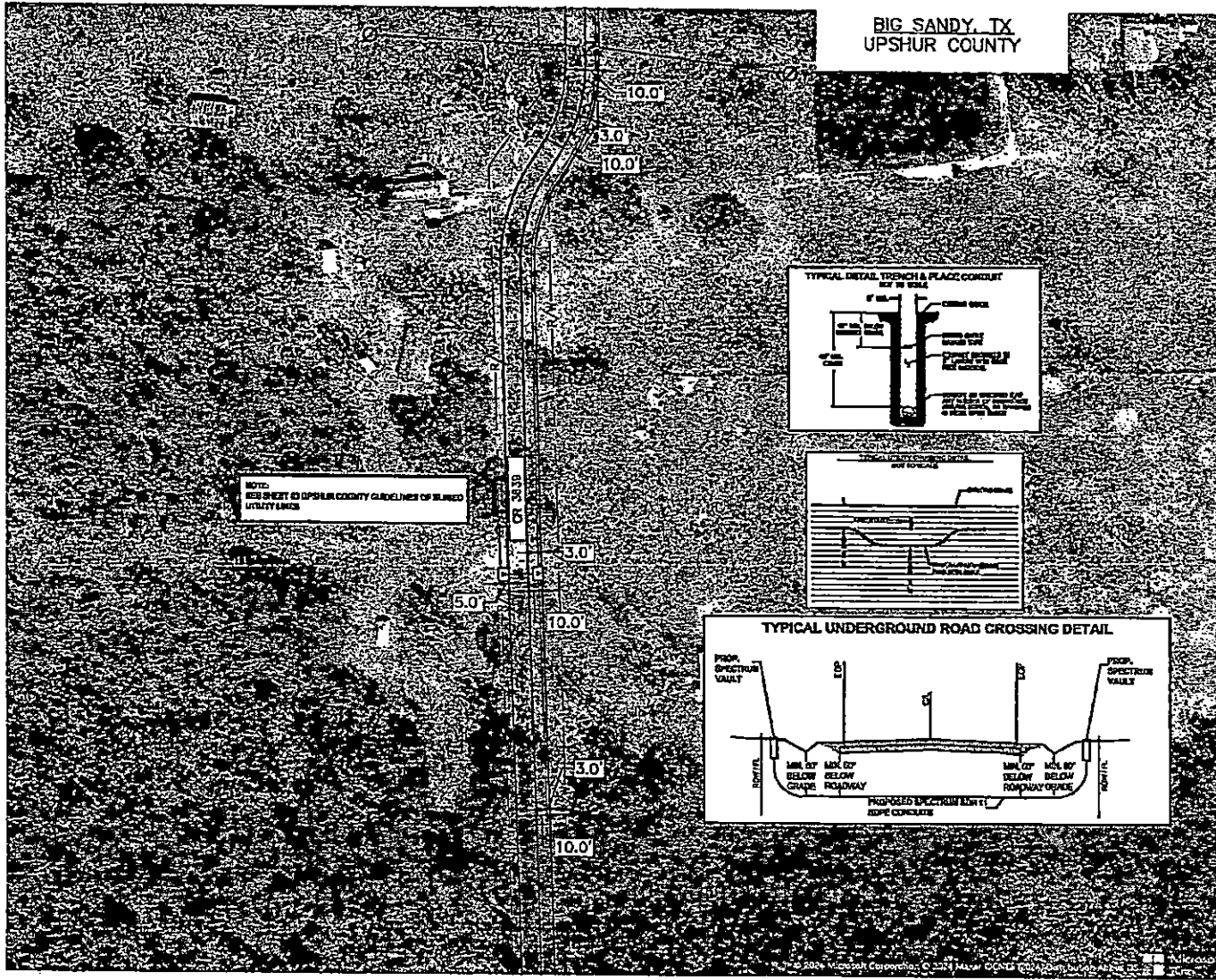

NOTE:  
SEE SHEET 43 UPSHUR COUNTY GUIDELINES OF BURIED UTILITY LINES

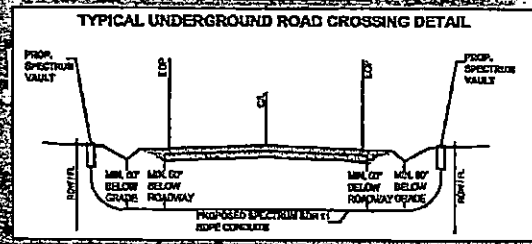
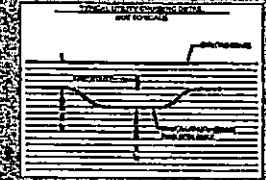
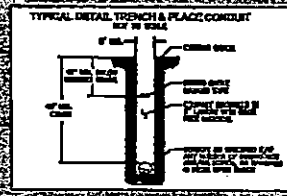

© 2024 Spectrum Communications, L.P. All rights reserved. Spectrum is a registered trademark of Spectrum Communications, L.P. LJA Telecom is a registered trademark of LJA Telecom, Inc. All other marks are the property of their respective owners.

**DRIVEWAY PERMIT APPLICATION**

TO: THE UPSHUR COUNTY COMMISSIONERS COURT  
COUNTY OF UPSHUR  
GILMER, TEXAS

PRECINCT 1

DATE April 8, 2024

Formal notice is hereby given that Dalton Summerfield, whose principal address is 7128 Forrestwood, does hereby purpose to place a driveway culvert within the ROW of County Road Forrestwood. Proposed construction will begin, if approved, on or after the 15th day of April, 2024. I, Dalton Summerfield, hereby attest that I have read the conditions set forth in this application and understand its contents. The culvert    will/   will not be placed by County equipment and personnel. This is a    new installation    extension.

SIGNATURE: 

TELEPHONE: 903-431-5731

**APPROVAL OF PERMIT APPLICATION**

The Upshur County Commissioners Court offers no objection to the location on the right of way of your proposed driveway culvert for the address shown above. The proposed driveway structure will be a 15 "x 20 ' culvert.

Recommended by 

APPROVED ON THIS \_\_\_\_\_ DAY OF \_\_\_\_\_, 20\_\_\_\_.

**DRIVEWAY PERMIT APPLICATION**

TO THE UPSHUR COUNTY COMMISSIONERS COURT  
COUNTY OF UPSHUR  
GILMER, TEXAS

PRECINCT 3

DATE April 4, 2024

Formal notice is hereby given that Kai Knapps, whose principal address is 4687 Hwy 154 E, does hereby purpose to place a driveway culvert within the ROW of County Road Lemon. Proposed construction will begin, if approved, on or after the 15th day of April, 2024 I, Kai Knapps, hereby attest that I have read the conditions set forth in this application and understand its contents. The culvert     will/     will not be placed by County equipment and personnel. This is a     new installation     extension.

SIGNATURE: 

TELEPHONE: 903-424-4852

**APPROVAL OF PERMIT APPLICATION**

The Upshur County Commissioners Court offers no objection to the location on the right of way of your proposed driveway culvert for the address shown above. The proposed driveway structure will be a 15 "x 20 ' culvert.

Recommended by 

APPROVED ON THIS \_\_\_\_\_ DAY OF \_\_\_\_\_, 20\_\_\_\_.